



Adam J. Metcalfe, SIOR

Post Office Box 2903, Mobile, AL 36652

(P) 251-432-2600 (C) 251-610-0069

adam@metcalfec.com www.metcalfec.com

FOR SALE

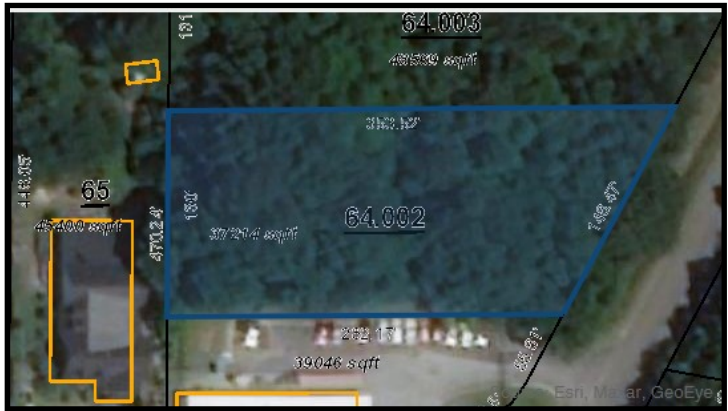
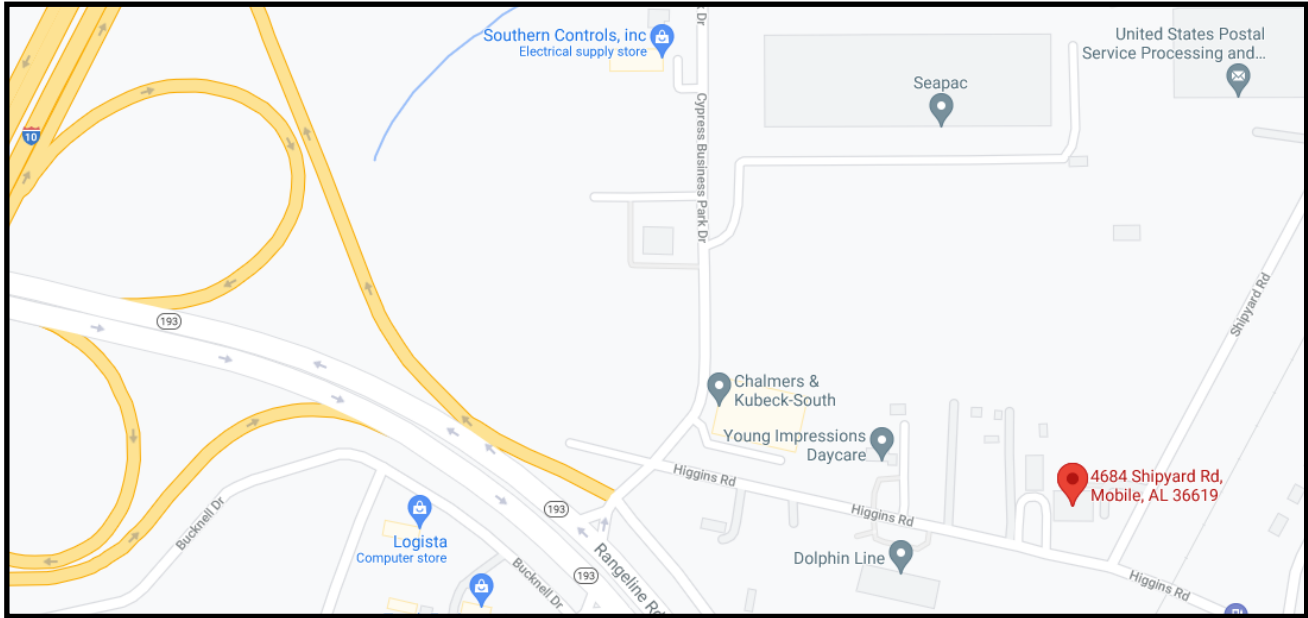

Location:	4684 Shipyard Road Mobile, AL
Lot Size:	37,200± square feet
Zoning:	B-3, Community Business
Purchase Price:	\$52,500

The information provided for by the company is subject to errors, omissions, changes, prior sale or lease and withdrawal from the market without notice by the owner. This information has been gathered from sources that are deemed to be reliable, however there is no warranty or guarantee to its accuracy or validity. You are hereby advised to independently verify the information presented herein.